

# Cassette Operating Instructions

1. Rotate the volume control to the ON position and adjust the volume and tone control.
2. Before inserting the cassette into the unit, check it for tape slack. If there is slack, insert a pen cap (or finger) firmly into spool hub and rotate counter-clockwise until the loop is flat.

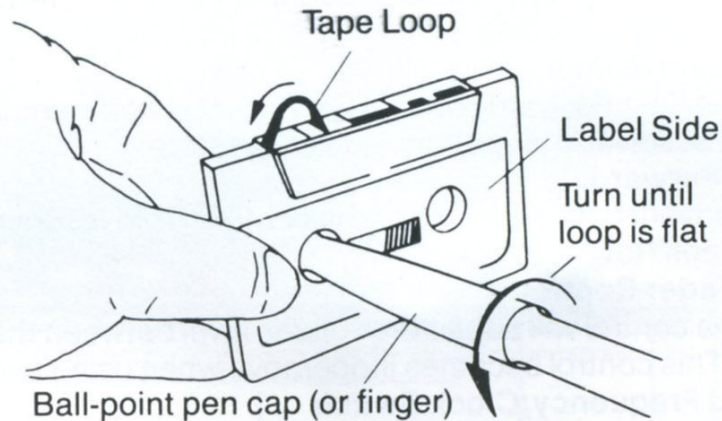

**Figure 6**

3. Insert the cassette cartridge through the tape door and into the player. The cassette will automatically engage and switch the unit from radio to tape play.
4. To reverse the direction of the tape and to listen to either side of the cassette tape, press the FFWD and REW buttons simultaneously. The direction of the tape is indicated with the small bars above the power indicators.
5. The tape may be Fast Forward "FFWD" and Fast Rewind "REW" by pressing the marked button. To resume normal play, lightly press the unused FFWD or REW button.
6. The DNR button is used to reduce background noise on the tape playback. Press the control IN to activate.
7. When using metal tapes, press the button next to the word "METAL." The illuminated graphic indicates metal tape equalization.
8. Press the button marked "EJECT" to remove the cassette cartridge.

**NOTE:** To prevent damage to tape and tape player, always remove the tape cartridge after playing.

# Automatic Music Search (AMS)

The search feature is designed to fast forward or rewind and automatically stop at blank sections of a pre-recorded tape. To properly operate this feature, be sure to follow these instructions:

## Music Search 1 Program

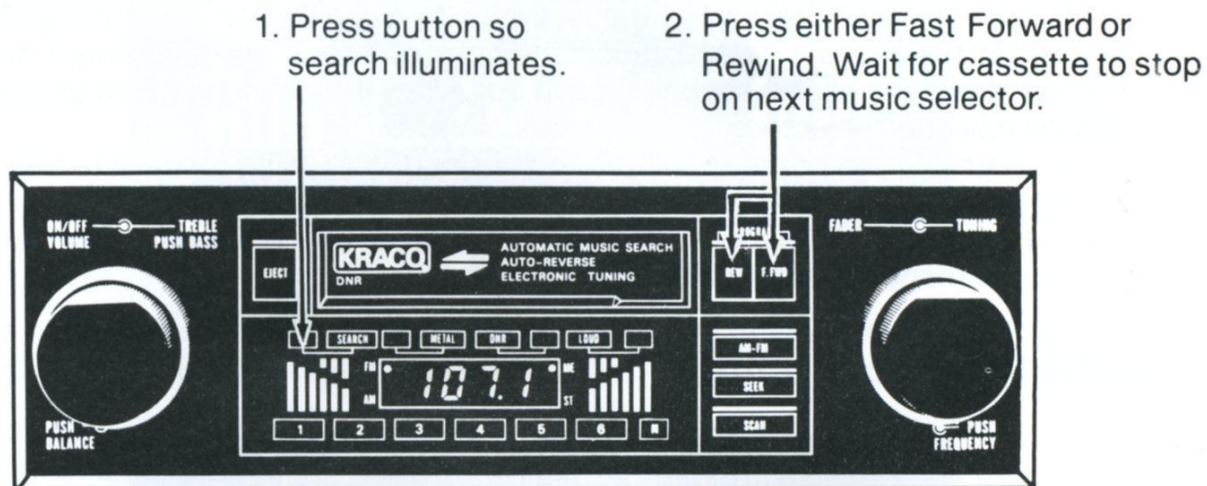

Figure 7

## Search Forward

1. Press the search button so letters illuminate.
2. Press the "FFWD" button and release.
3. Allow the tape player to search to the next music selection. The tape will automatically stop and begin to play.

## Search Reverse

1. Press the search button so letters illuminate.
2. Press the "REW" button and release.
3. Allow the tape player to search to the next music selection. The tape will automatically stop and begin to play.

**NOTE:** The Search (AMS) feature may not function perfectly with tape containing these types of pre-recorded material:

- Intermittent material
- Soft classical music, solo performance, modern jazz, etc.
- Recorded at a low level
- Selections are separated by less than three seconds
- Selections between music are not free of noise.

**NOTE:** To Fast Forward or Rewind normally, this feature must be in off position.



# AM/FM Operating Instructions

1. Rotate the volume control to the ON position and adjust the volume and tone control.
2. Select either the AM or FM radio band. The small illuminated lights next to the letter "AM" or "FM" indicate the selected radio band.
3. Rotate the tuning knob to electronically select radio stations. The frequency of the station along with the stereo indication will be shown on the display.
4. To automatically select radio stations, press the Scan button. The tuning will move forward to the next strongest station and hold for 8 seconds. If you want to hold this station, press the scan a second time. If not, allow the tuning to move until a desired station has been selected.
5. Seek control, when pressed, will move the electronic tuning forward to the next strongest station.
6. The loudness (LOUD), when letters are illuminated, will compensate for loss of frequency response at low volume.

## Station Pre-Set Controls

1. Press the ME button and release.

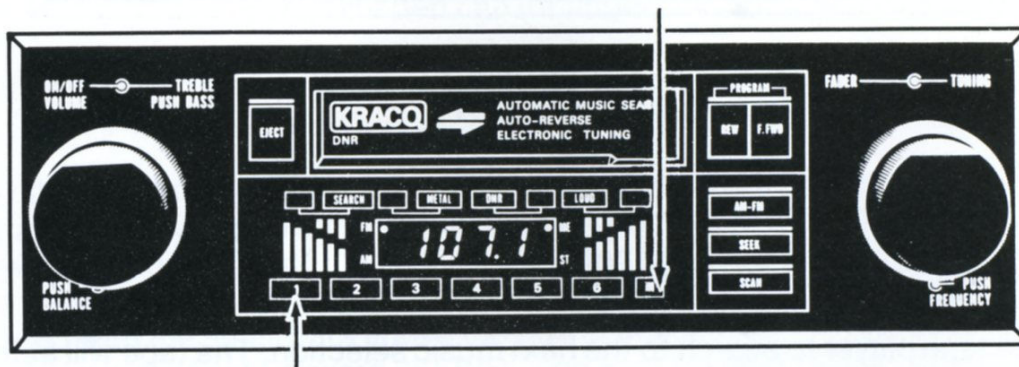

2. Press one of the numbered buttons and release.

**Figure 8**

1. Select an AM or FM radio station.
2. Press the memory "M" button IN and release.
3. The ME indicator will illuminate and within 8 seconds press one of six (6) electronic pushbuttons.
4. Each button may be set to one (1) FM and one (1) AM station.
5. To reset any pushbutton for a new station, follow the above steps.

## Digital Display and Time Set

### Time Set

1. Turn power on and allow the display to change to time.
2. Press and hold the memory (M) button.
3. Rotate the tuning knob clockwise to change the minute digits and counter-clockwise to change the hour digits.



## Digital Display

1. The display will register the frequency digits when using the pushbuttons, scan, seek or tuning controls. After 8 seconds, the display will automatically change from frequency to time display. To recall the frequency, press the Tuning Control.
2. The color scale indicates the output power to the left and right speakers. This visual reference is used to prevent over driving speakers and stereo's audio output.

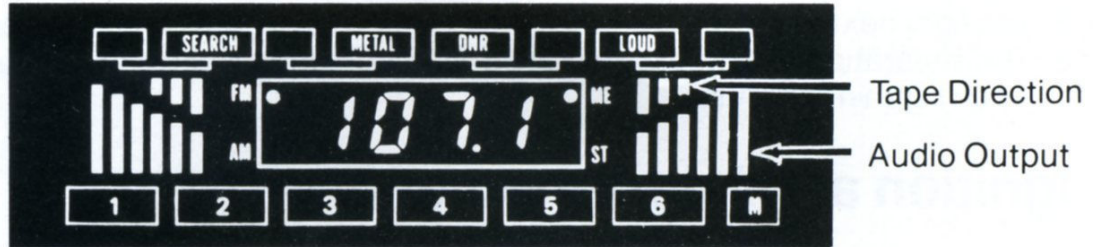

Figure 9

3. Each of the function control knobs utilize illuminated graphics for easy reference. Press knob to turn graphics on and off.



Figure 10

## Tape Player Maintenance

Periodic cleaning of the tape head and capstan shaft will ensure good reproduction of music and trouble-free operation. Cleaning of the tape head should be done every 20 to 30 hours of operation or when the high tones have become less clear.

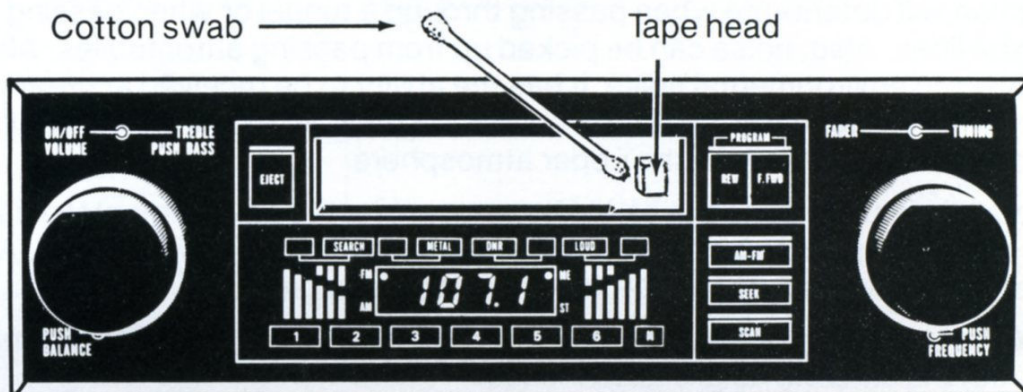

Figure 11

1. Use a cassette cleaning cartridge if available. If one is not available, use a cotton swab soaked in isopropyl (rubbing) alcohol. If using a cleaning cartridge follow the instructions included with it.
2. While holding the tape door open, locate tape head to the right of the opening and in the center of the unit.
3. Clean the tape head with the cotton swab.
4. Clean the capstans and pinch rollers with the cotton swab.
5. Allow the tape head, capstans and pinch rollers to dry before operating.